

STEP 1:  
CUT A 12"X12"  
NOVATAK SQUARE

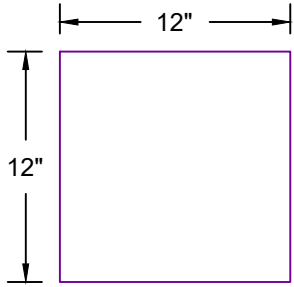

STEP 2:  
FOLD THE SQUARE IN  
HALF IN BOTH  
DIRECTIONS TO FIND  
THE CENTER OF THE  
NOVATAK SQUARE

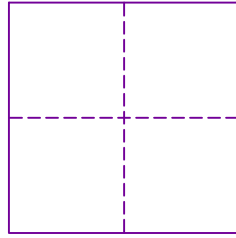

STEP 3:  
CUT ONE FOLD LINE TO  
THE CENTER OF THE  
NOVATAK SQUARE

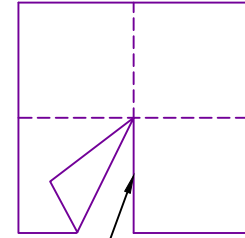

CUT

STEP 4:

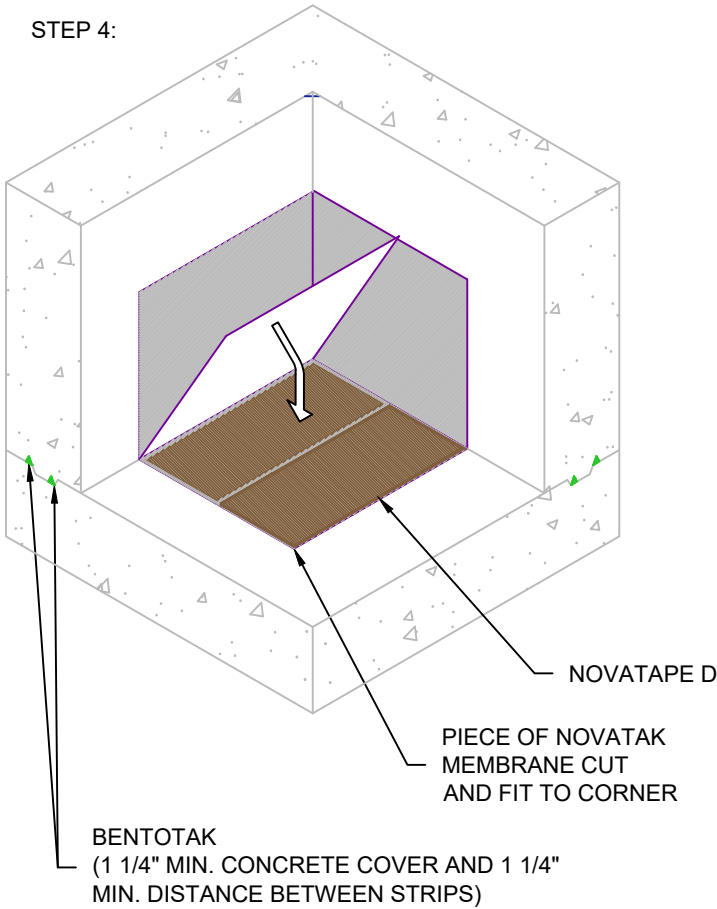

STEP 5:

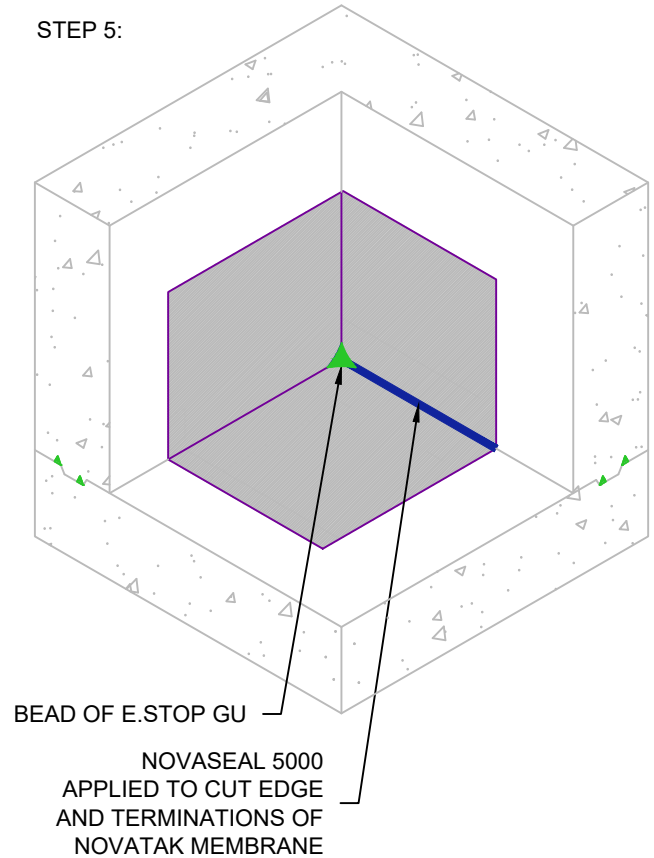

G:\My Drive\Epro Master Folder\Drafting\Details\Shoring\Novatak\50.381.3.1 CORNER - INSIDE - FULLY ADHERED FIELD FORMED.dwg [Detail] July 01, 2021 - 10:04am

CORNER - INSIDE - FIELD FORMED



SYSTEM NAME	DRAWING NUMBER
NOVATAK	50.381.3.1
DRAFTER	DATE
RJT	5/06/2021

**NOVATAK**

AS A SUPPLIER OF FINISHED PRODUCTS ONLY, EPRO SERVICES, INC. DOES NOT ASSUME RESPONSIBILITY FOR ERRORS IN DESIGN, ENGINEERING OR DIMENSIONS. THE PROJECT TEAM MUST VERIFY ALL DIMENSIONS AND SUITABILITY OF DETAILS. THE PRODUCTS LISTED ARE TRADEMARKS OF EPRO SERVICES, INC.

NTS

PAGE 1 OF 1