

A diagram of a square with side length 8 inches. The top side is labeled $8 + "$ and the left side is labeled $8 + "$.

CUT & TRIM

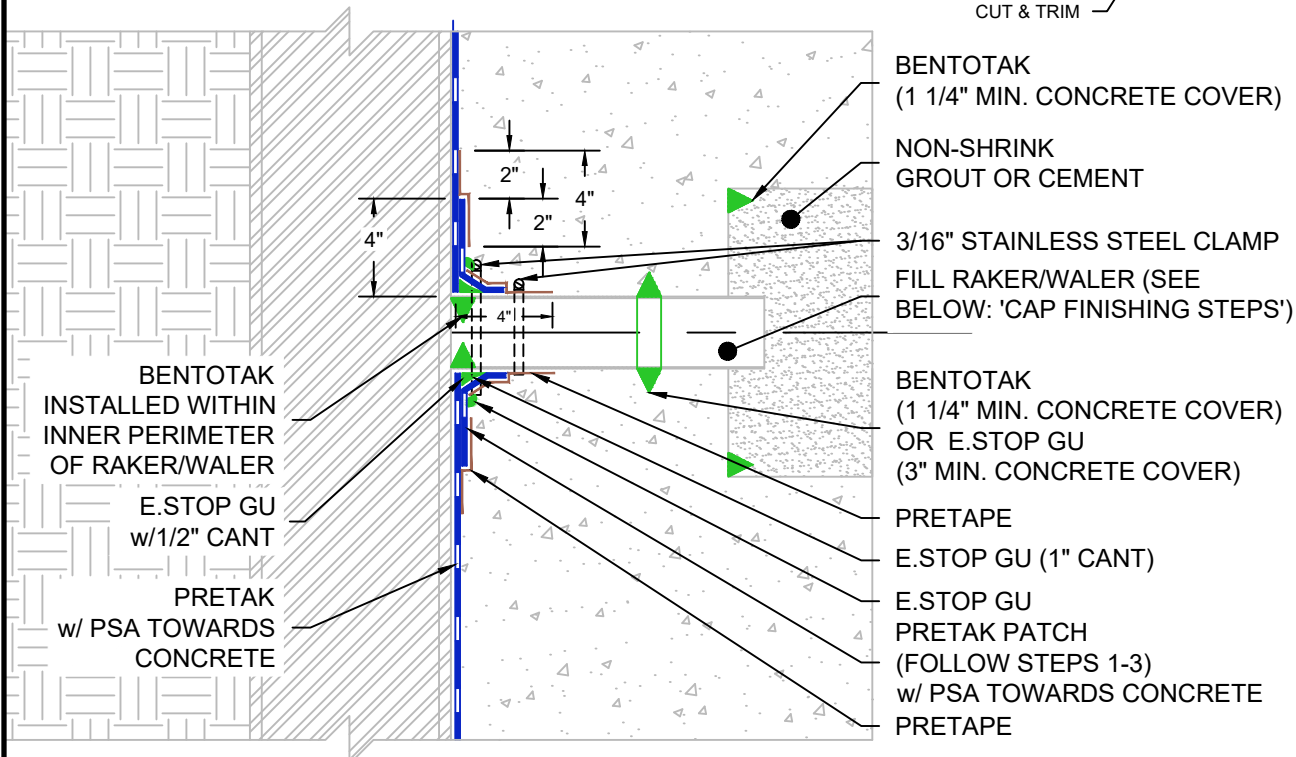

- 1) BLOCKOUT OR SAW CUT A SQUARE OPENING A MINIMUM OF 6" FROM THE OUTSIDE OF THE RAKER /
WALER -IF SAW CUT, BREAKOUT CONCRETE AROUND PIPE
- 2) CUT RAKER / WALER A MINIMUM OF 4" DOWN BELOW TOP OF SLAB
- 3) APPLY BENTOTAK AROUND THE INNER PERIMETER OF RAKER / WALER
- 4) FILL BOTTOM OF RAKER PIPE WITH A MINIMUM OF 2" BENTONITE GRANULES OR BENTONITE-CEMENT
MIX
- 5) FILL RAKER / WALER WITH NON-SHRINK HYDRAULIC GROUT OR CEMENT
- 6) APPLY BENTOTAK AROUND THE INNER PERIMETER OF BLOCKOUT/SAW CUT AREA
- 7) FILL BLOCKOUT/SAW CUT AREA WITH NON-SHRINK GROUT, CEMENT, OR SHOTCRETE

- 1) PRETAK MEMBRANE BOOT MUST BE FIT SNUG AROUND RAKER/WALER WITHOUT FOLDING OR FALLING DOWN. PRETAPE MUST BE USED TO COMPLETELY SEAL BETWEEN BOOT AND PILE, TIGHTEN HOSE CLAMP AS TIGHT AS POSSIBLE WITHOUT DAMAGING THE MEMBRANE
- 2) SPACE PENETRATIONS A MINIMUM OF 6" FROM SLAB EDGE, CORNERS, WALLS, OR OTHER PENETRATIONS.

BLINDSIDE VERTICAL PENETRATION - RAKER & WALER



PRETAK

RJT

51.325.1

7/26/2022

PRETAK

NTS

PAGE 1 OF 1